

MIG/MAG Welding Torch MB 36 KD air cooled



BINZEL. The right welding torch for every job!

BINZEL air cooled welding torches incorporate the high quality and technology needed for trouble-free performance whatever the welding job. All BINZEL torches are constructed to the highest standards and offer the greatest working comfort.

BINZEL torch features:

- Optimum cooling of the torch, extending torch life
- An ergonomic handle, ensuring comfort in every position
- Light and flexible cable assemblies, designed to reduce fatigue

Technical data (EN 50 078):

Rating: 300A CO₂
270A Mixed Gases M 21
(DIN EN 439)
60% Duty Cycle
Wire sizes: 0.8 - 1.2

- Robust construction for durability and extended torch life
- A connecting system that allows easy torch changes

Rated using power source with VDE standard volt/amp characteristic ($U=14+0,05xI$).
When pulse welding, reduce rating by 35%.

Type	Handle/Version	3.00 m long Part no.	4.00 m long Part no.	5.00 m long Part no.
MB 36 KD	Ergonomic	014.0143	014.0144	014.0145
AUT 36 KD	Handle tube, straight	914.0013	914.0015	914.0027
	Handle tube, bent	914.0014	914.0028	914.0029

For welding and cutting come to the point.



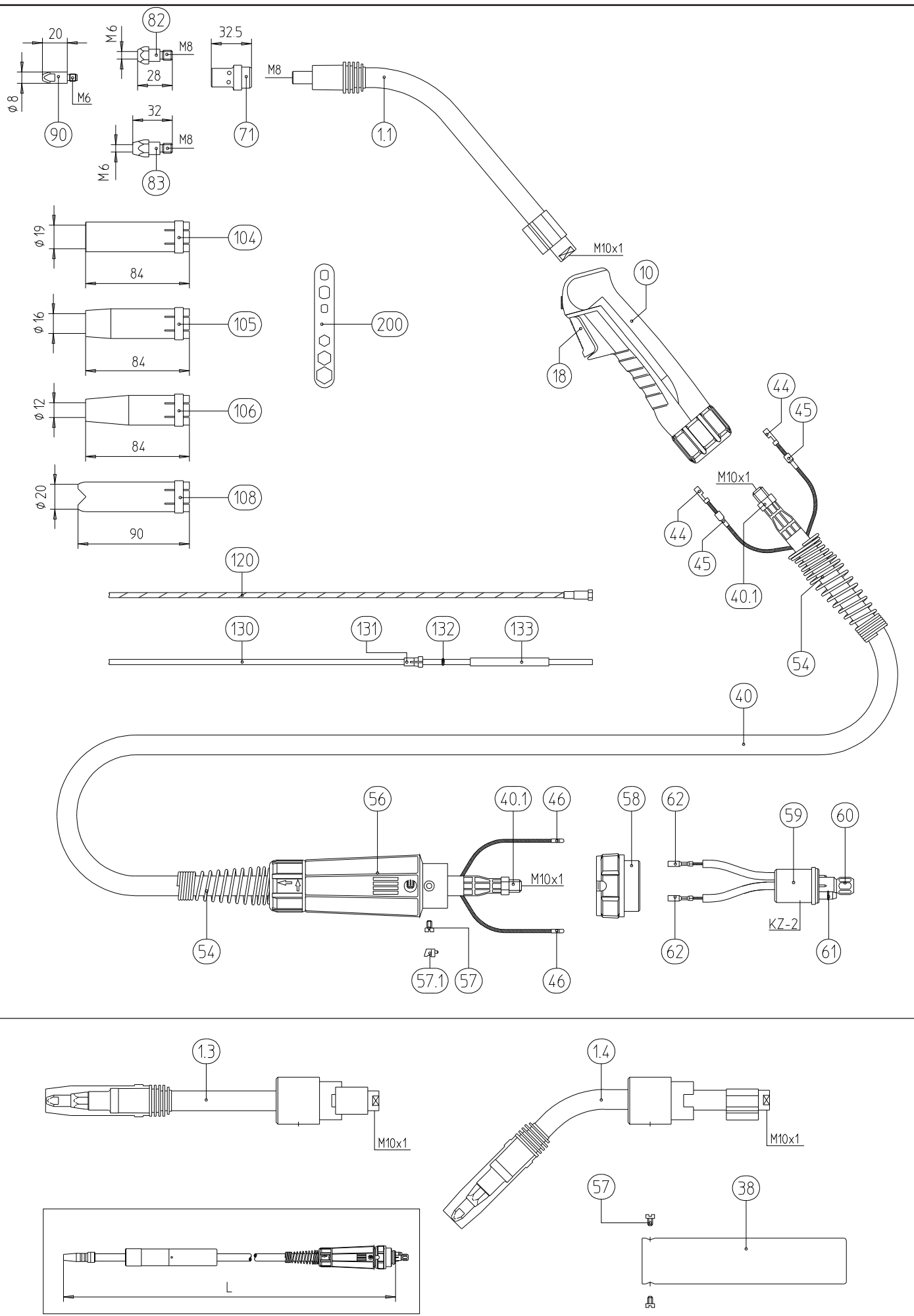

Build group	Pos.	Description	Specifications	Part no.
Torch	1.1	Swan neck MB 36 KD, 50° bent		014.0006
	1.3	Swan neck AUT 36 KD, straight		914.0002
	1.4	Swan neck AUT 36 KD, 45° bent		914.0001
Handle	10	Ergonomic handle, cpl., with trigger		180.0076
		Handle, top		400.0333
		Handle, bottom		400.0335
		Lock ring NW 31		400.0297
		Screw 18x8	20 pcs.	400.0340
		Screw 3.5x9.5	20 pcs.	079.0034
	18	Trigger 2 pol.		185.0031
	38	Handle tube AUT		180.0001
Cable assembly	40	Bikox power cable 3.00 m	B7	160.0364
		Bikox power cable 4.00 m	B7	160.0379
		Bikox power cable 5.00 m	B7	160.0391
		w/o. fig. Outer cover Ø 20x1.5	per meter	105.0005
	40.1	Hexagon nut M10x1	10 pcs.	001.0009
	44	Trigger wire connector	20 pcs.	175.0022
	45	Insulating sleeve	20 pcs.	400.0119
	46	Trigger wire connector, male	20 pcs.	175.0004
	54	Cable support spring		500.0343
	56	Cable support machine side		501.2248
	57	Screw M4x6	20 pcs.	000.0552
	58	Adaptor nut		500.0213
	59	Central adaptor block KZ-2		501.0003
		Central adaptor block KZ-2 without control leads		501.0028
	60	Nut M10x1	10 pcs.	501.0082
	61	O-ring 4x1	20 pcs.	165.0002
	62	Trigger wire connector, female	20 pcs.	175.0003
Wear parts	71	Gas diffusor black	• 10 pcs.	014.0021
		Gas diffusor long life	10 pcs.	014.0026
		Gas diffusor white	10 pcs.	014.0261
	82	Contact tip holder M6, 28.0 mm (short)	• 10 pcs.	142.0005
	83	Contact tip holder M6, 32.0 mm (long)	10 pcs.	142.0011
	90	Contact tip M6 E-Cu, Ø 0.8	10 pcs.	140.0051
		Contact tip M6 E-Cu, Ø 1.0	10 pcs.	140.0242
		Contact tip M6 E-Cu, Ø 1.2	• 10 pcs.	140.0379
		Contact tip M6 CuCrZr, Ø 0.8	10 pcs.	140.0054
		Contact tip M6 CuCrZr, Ø 1.0	10 pcs.	140.0245
		Contact tip M6 CuCrZr, Ø 1.2	10 pcs.	140.0382
		Contact tip M6 E-Cu, Ø 0.8 for alu wire	10 pcs.	141.0001
		Contact tip M6 E-Cu, Ø 1.0 for alu wire	10 pcs.	141.0006
		Contact tip M6 E-Cu, Ø 1.2 for alu wire	10 pcs.	141.0010

Build group	Pos.	Description	Specifications	Part no.
Wear parts	104	Gas nozzle, cylindrical ND Ø 19.0	10 pcs.	145.0045
	105	Gas nozzle, conical ND Ø 16.0	• 10 pcs.	145.0078
	106	Gas nozzle, tapered ND Ø 12.0	10 pcs.	145.0126
	108	Spot weld, gas nozzle ND Ø 20.0	10 pcs.	145.0172
	120	Insulated liner 1.5/4.5 blue with nipple for wire ¹⁾ Ø 0.6-0.8	for 3.00 m	124.0011
			for 4.00 m	124.0012
			for 5.00 m	124.0015
		Insulated liner 2.0/4.5 red with nipple for wire ¹⁾ Ø 1.0-1.2	• for 3.00 m	124.0026
			• for 4.00 m	124.0031
			• for 5.00 m	124.0035
	130	Teflon core liner 1.5/4.0 blue with collet and o-ring for wire ²⁾ Ø 0.6-1.0	for 3.00 m	126.0005
			for 4.00 m	126.0008
			for 5.00 m	126.0011
		Teflon core liner 2.0/4.0 red with collet and o-ring for wire ²⁾ Ø 1.0-1.2	for 3.00 m	126.0021
			for 4.00 m	126.0026
			for 5.00 m	126.0028
		Carbon Teflon core liner 1.5/4.0 with collet and o-ring for wire ²⁾ Ø 0.6-1.0	for 3.00 m	127.0002
			for 4.00 m	127.0003
			for 5.00 m	127.0004
		Carbon Teflon core liner 2.0/4.0 with collet and o-ring for wire ²⁾ Ø 1.0-1.2	for 3.00 m	127.0005
			for 4.00 m	127.0007
			for 5.00 m	127.0008
	131	Collet for core liner at Ø 4.0	20 pcs.	131.0001
	132	O-ring 3.5x1.5	20 pcs.	165.0008
	133	Guide tube for core liners up to Ø 4.0	to 200 mm	129.xxxx
	200	Spanner	10 pcs.	191.0001

¹⁾ Applicable for GMA welding of un-alloyed and low alloyed steels (DIN 8555 and 8559).

²⁾ Applicable for GMA welding of aluminium (DIN 1732), copper and copper alloys (DIN 1733) and nickel/nickel alloys (DIN 1736); Also for use with GMA welding of stainless and heat resistant steels (DIN 8556).

- Standard - Equipment

For welding and cutting come to the point.



Alexander Binzel Schweißtechnik GmbH & Co. KG
P.O. Box 10 01 53 • D-35331 Gießen
Tel.: ++49 (0) 64 08 / 59-0
Fax: ++49 (0) 64 08 / 59-191
Internet: <http://www.binzel-abicor.com>